

MOZAYO

M246T

ASSEMBLY INSTRUCTIONS

PRIOR TO ASSEMBLY

- The total weight of the table top section is ~ 120 lbs.
- The total weight of the leg and base plate is ~ 200 lbs.
- A minimum of 2 (3 recommended) people required for the assembly.
- Decide on the final location of the unit before assembly.
- Make sure there is a power outlet near by. 5' to 6' cord length available from under the base of the unit. Add additional extension if necessary.
- For seamless install, the unit should be placed over a floor power outlet.

TOOLS NEEDED

- (Item A) Power Tool Drill/Driver
- (Item B) 1/4" Square Drive Ratchet Wrench
- (Item C) 1/4" Square Drive Thin-Wall Power Socket, 6-Point Standard, 1/2" Size (McMaster Carr [54655A57](#))
- (Item D) 1/4" Square Drive Thin-Wall Power Socket, 6-Point Standard, 7/16" Size (McMaster Carr [54655A56](#))
- (Item E) Adapter 1/4" Square Male, 1/4" Hex Male, 6" Long (McMaster Carr [7236A45](#))
- (Item F) Quilted Protective Pad (Moving Blanket) Minimum Size 60" x 36" (McMaster Carr [2256T53](#))



Finalize Location

- **NOTE:** Make sure to move the crates to the desired installation location prior to moving forward on any of the steps.



Table Top Crate

- Clean and prepare and working surface (minimum size 60" x 36" table) and add blanket (*Tools - Item F*).
- **THIS STEP REQUIRES A MINIMUM OF 2 PEOPLE.** Remove the top lid of the crate with the table top display and using the **RED arrow** locations to pull the display out.
- Note: remote will be inside this box.



Leg & Base Crate

- Open the crate with the leg + base assembly.
- Note the items in the box.

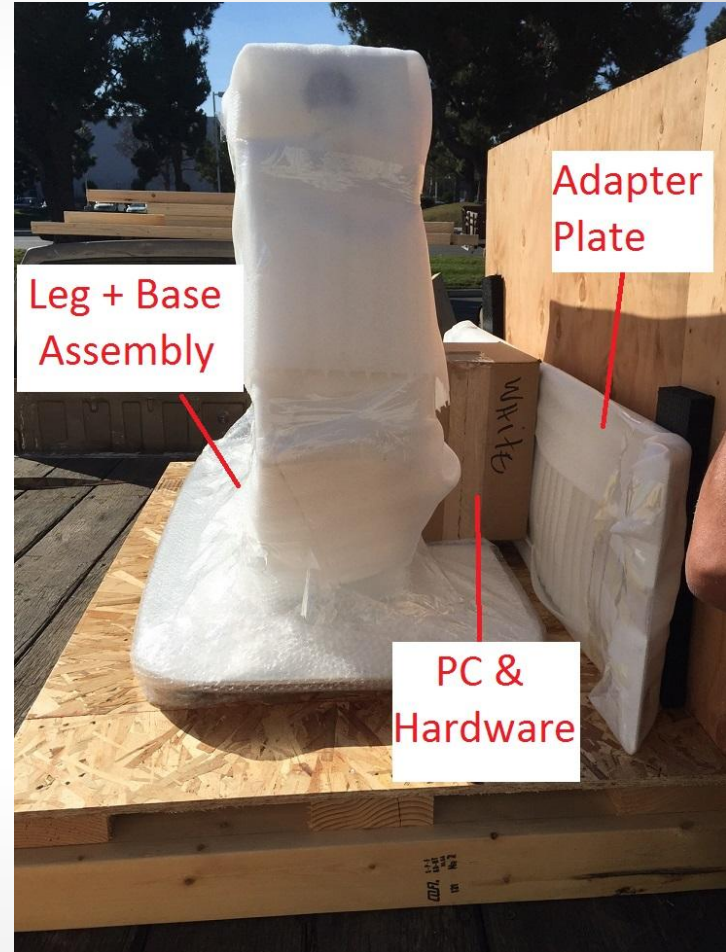

Included Items

- Items inside the box:
- PC
- Manuals and Windows CD
- Hardware for installation of adapter bracket
- USB Type B to Type A for front external USB
- HDMI (display side) to DVI (PC side) cable
- Mini wireless keyboard



Step 1

- With the glass side facing down, remove the Displayport cable, monitor power cable and touch controller power cable in (RED). These items are installed in the leg assembly and can be kept for spare parts.
- USB cable will need to be routed through the grommet on the right side of the leg (BLUE).

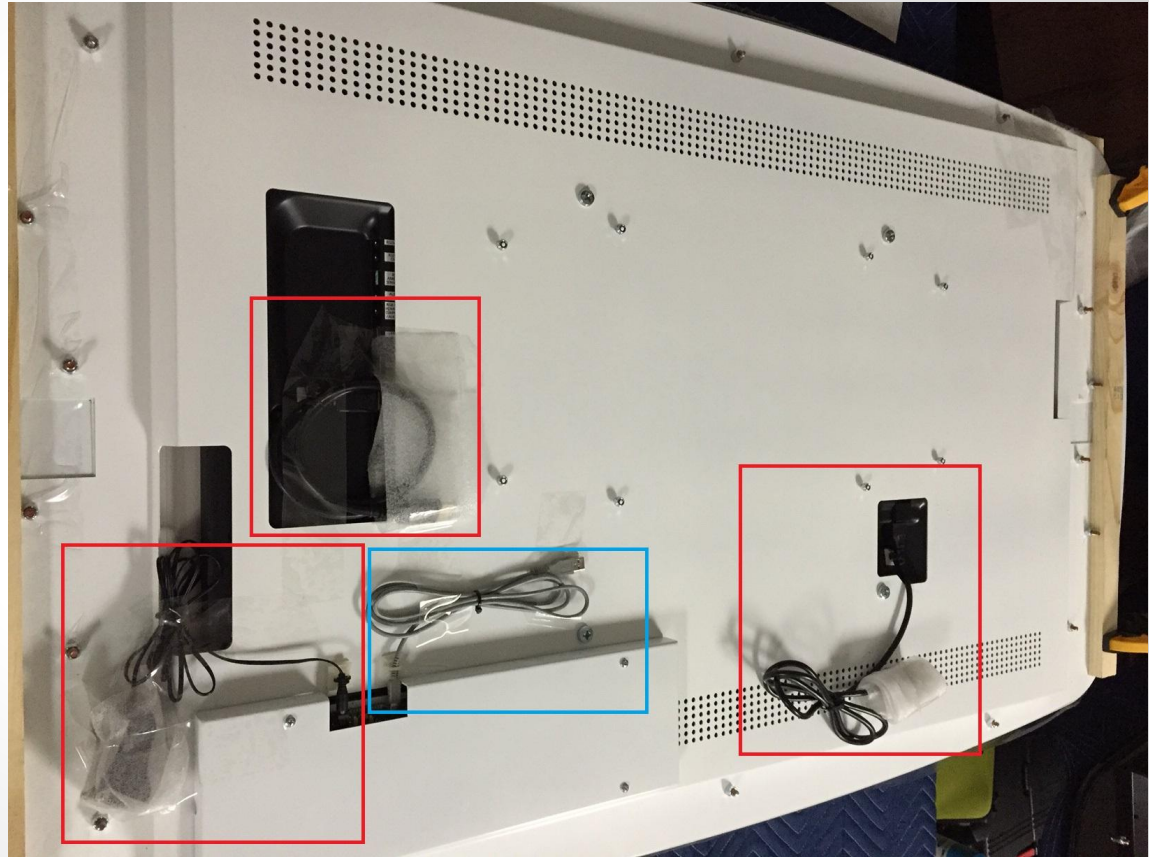

Step 2

- Prepare (*Tools - Items B+D*).
- With the glass side facing down, remove the (qty 8) ¼"-20 nuts in the locations marked in **RED**.
- Disgaurd these as (8) new ones are provided.

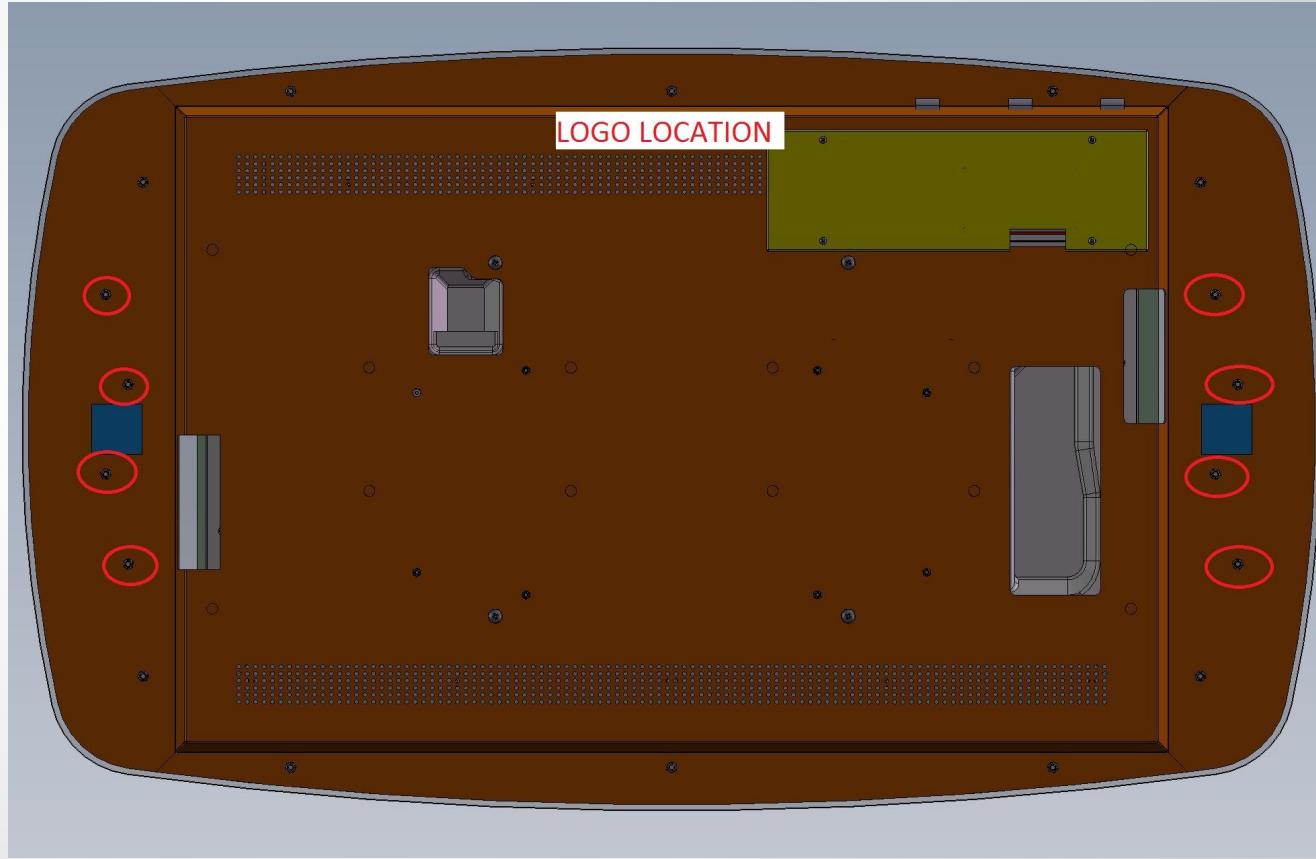

Step 3

- Skip step if adapter bracket is already installed.
- Attach the leg adapter bracket to the (8) studs using the 1/4"-20 nuts provided.
- NOTE: Make sure bracket orientation is as shown with the cutouts to match respective locations.



Step 4

- NOTE: Make sure the table location is set before this step. **A MINIMUM OF 2 PEOPLE REQUIRED.**
- Pull out the leg assembly out of the crate.
- Carefully tip the leg to get access to the bottom and plug in the power cable to an outlet. Floor outlet recommended to achieve seamless installation.



Step 5

- NOTE: Make sure the table location is set before this step.
- **A MINIMUM OF 2 PEOPLE REQUIRED.** Lift the table top and slowly lower onto the leg assembly. Align studs into the (8) holes.

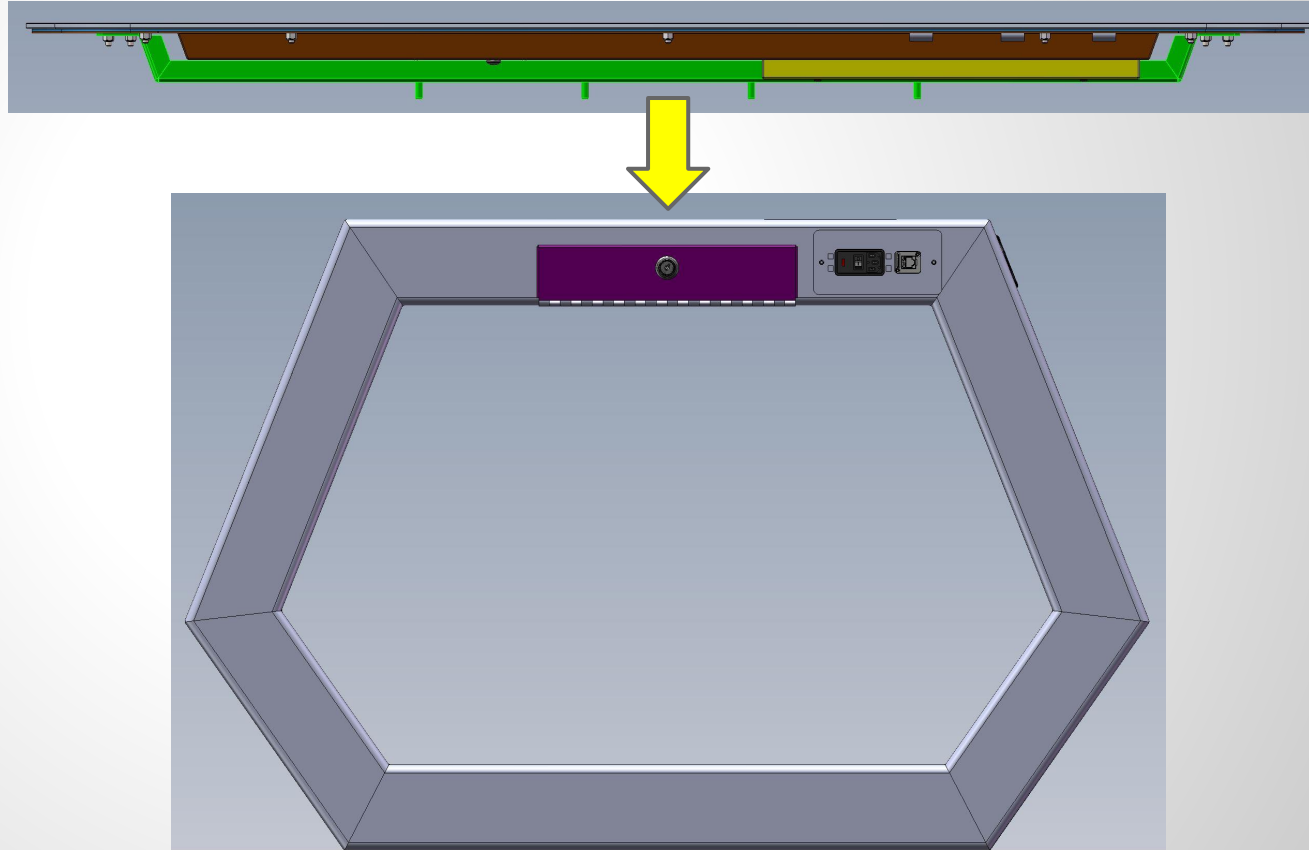

Step 6

- Prepare (*Tools - Items A+E+C*) a power drill with the 6" long $\frac{1}{4}$ " square-hex adapter and 6-Point Standard, $\frac{1}{2}$ " Size socket.
- Screw on the (8) $\frac{5}{16}$ "-18 hex-nut supplied from the bottom up.
- **NOTE: Make sure to have the torque on the lowest setting and drive slowly to prevent the thread from stripping.**

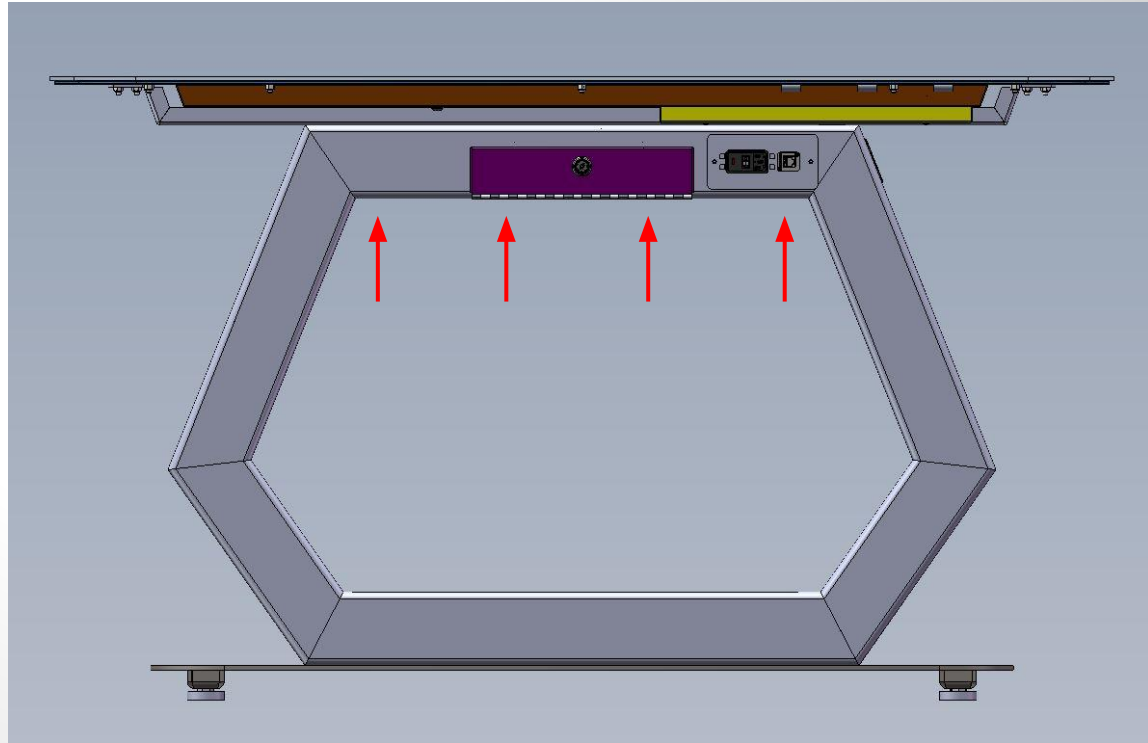
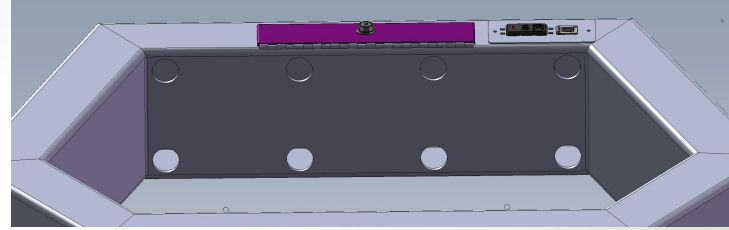

Step 7

- Route the monitor power cable on the display.
- (Optional) With the supplied zip ties and sticky square for tie down.

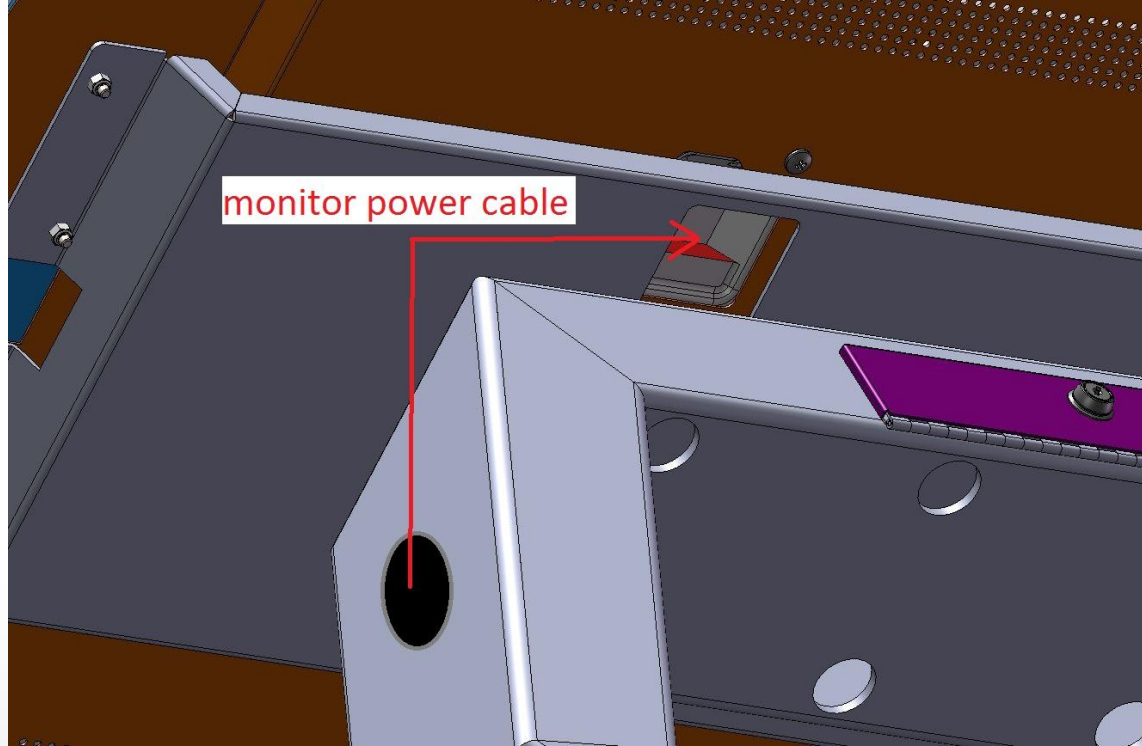

Step 8

- Route the Touch USB cable to the PC (Yellow).
- Route Touch Power to controller (Blue).
- Plug in HDMI to the display and route the DVI side to PC (Green).
- (Optional) With the supplied zip ties and sticky square for tie down.

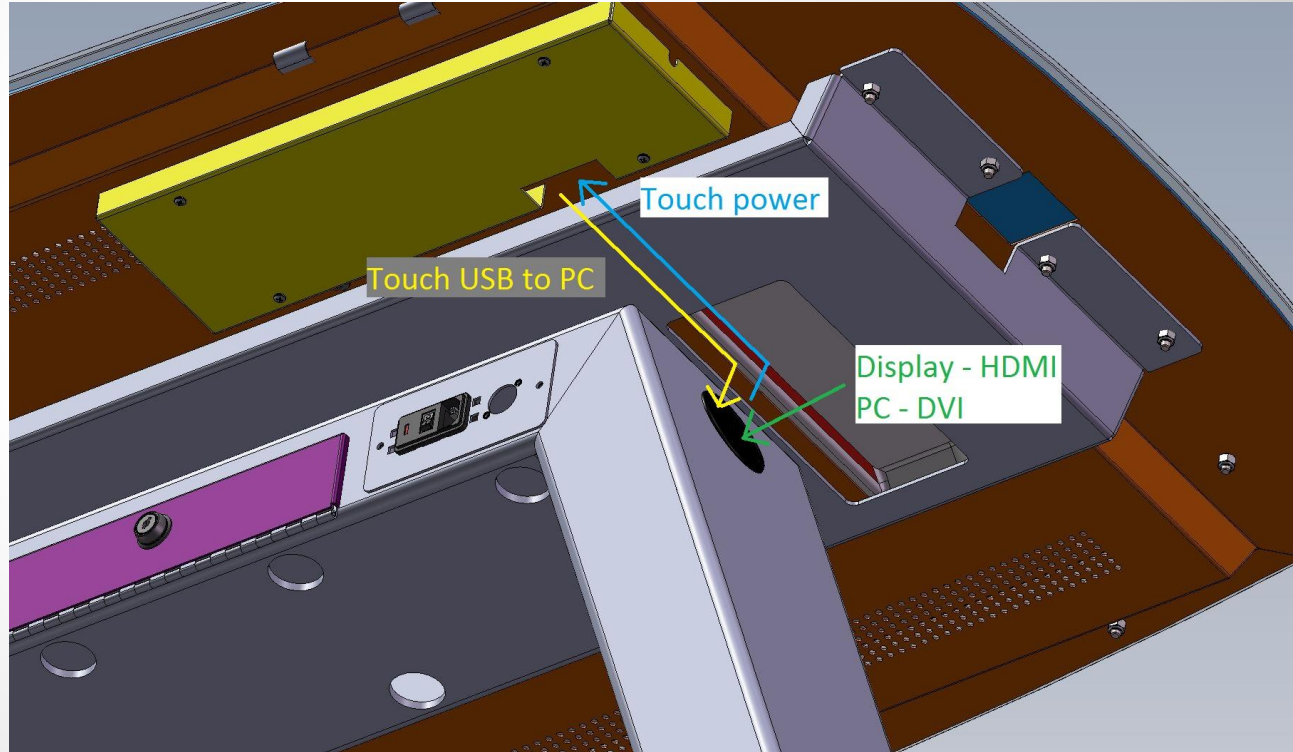

Step 9

- Plug in the USB Type B on the back of the USB module and connect the Type A USB side to the PC.
- Install the USB face plate module with the supplied screws.



Step 10

- PC orientation recommendation for power button (left side) and DVI connection (right side)
- Place PC inside the opening and connect:
 - PC power
 - Touch USB
 - Video (DVI)
 - keyboard USB for charging (optional)
 - External USB (optional)
- Turn on the power and enjoy!

